



# Fascia & Barge Boards

Designed to suit any roof



EVERITE's comprehensive range of Nutec fascias and barge boards have been designed to suit virtually any roof, whether slates, tiles or sheeting. They provide a functional finish by protecting the underlying timber structure from the elements, as well as adding visual impact to the building.

Nutec fascias and barge boards are ideal to cover up or replace weathered or rotten timber fascias and boards on old buildings.

In high wind areas barge boards form an important component of the roof structure, as they protect slates or tiles from being dislodged by the wind at the gable ends.

Nutec barge boards are:

- Cost effective
- Light in weight and easy to cut and install (tungsten tip blades are needed to cut)
- Not affected by moisture and resistant to rot and corrosion
- Easy to paint and will accept any water-based paint without pre-treatment.

Nutec Fascias are reinforced with organic fibres in a calcium-silicate-hydrate binder and do not have asbestos as reinforcement and carry the SABS mark under specification SANS 803.

**Nutec barge boards are manufactured from cement, synthetic and organic fibres.**

General Design Criteria ..... 3

Handling and Storage ..... 3

General Erection Guidelines ..... 4

Installation Procedures

- Nutec Fascia Boards ..... 5
- Nutec Barge Boards ..... 8

Product Range

- Nutec Fascia Boards ..... 10
- Nutec Barge Boards ..... 11

Fixing Accessories ..... 11

Sample Bill of Quantities ..... 13

Company - Contact Details ..... 14

### Catalogue Information

The information contained in this catalogue serves as a general guide only and should not be accepted as the standard for all construction. Consult EVERITE for designs of a special nature.

This service is provided free of charge and without obligation, but architects, engineers and specifiers must finally approve the acceptability in terms of the design and construction criteria, as well as other implications.

### Supporting Structure

To ensure a high standard of finish, it is essential that the supporting structure is accurate. Warped, twisted or poor quality timber work will reflect in the final appearance of the Nutec fascia or barge boards.

### Made to Order Barge Boards

The uncured fibre-cement sheet lends itself to the manufacture of specially made Nutec barge boards to suit specific applications.

Based on volumes, the complexity of the article, approval of drawings and the manufacturing process, **a minimum lead time of 8 weeks can be expected.** This delay should therefore be allowed for in the ordering and construction programme.

**Please check with EVERITE to obtain more specific information.**

### Fixing Accessories

A range of jointing systems for Nutec fascias and barge boards is available from EVERITE and full details are given under **Fixing Accessories, Page 11 and 12.**

### Site Service

Site service personnel are available on request and at no charge, to provide assistance on recommended storage, handling and erection of the Company's products.

## Handling and Storage

Nutec fascias and barge boards are manufactured from composite materials containing mainly cement and may be damaged under excessively high shock loads. Reasonable care should therefore be taken to ensure that the products are not dropped or subjected to rough handling.

**A smooth level area should be made available where these products can be stacked safely.**

**The stacks should be supported on timber bearers at maximum 400mm centres and stacked clear off the ground. They should be protected against possible damage.**

- The creation of excessive dust while working with the product should be avoided and therefore the using of fast turning power tools such as angle grinders are not recommended.

Ordinary carpenters' tools can be used effectively.

Refer to the brochure '**Finishing & Maintenance**' for more details.

- All rafter ends, purlins and battens must be accurately lined up and trimmed.
- Where the spacing between the rafters is greater than 900mm, supporting timber must be fixed between the rafters as additional support for the fascia boards. **Refer Fig. 2, Page 6.**
- On gable ends trimmer battens must be fixed to the end of battens or purlins. This will provide a neat edge for the barge board and avoid fixing into end grain of the timber which is not good practice. **Refer Fig. 7, Page 8.**
- Although Nutec fascias and barge boards are nailable, when fixing near to the edge but not closer than 25mm, holes must be drilled and not punched.

**An ordinary hand drill and steel drill bits specially sharpened to a 20° angle are recommended. Do not use hammer drills and masonry bits.**

- Nutec fascias and barge boards can be fixed directly onto the timber structure using nails or wood screws.
- Joints of Nutec fascias and barge boards should not be made at the fixing points but between them.
- Nutec fascias and barge boards do not require paint for protection, but will accept any water-based paint without pre-treatment.
- Ideally, painting of the Nutec fascias and Nutec barge boards should be done prior to erection with only touching up to be done after installation.
- Nail and screw heads must be coated with a rust-resistant undercoat before painting.

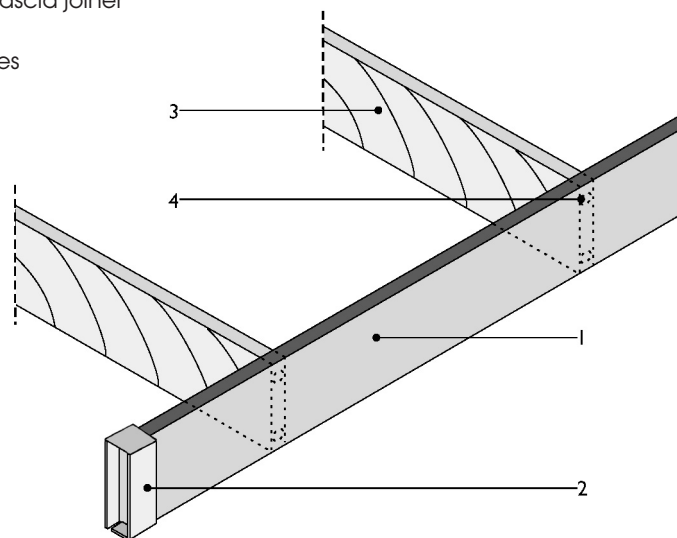
### Nutec Fascia Boards

The sketches which follow will assist with the correct installation of Nutec fascia boards.

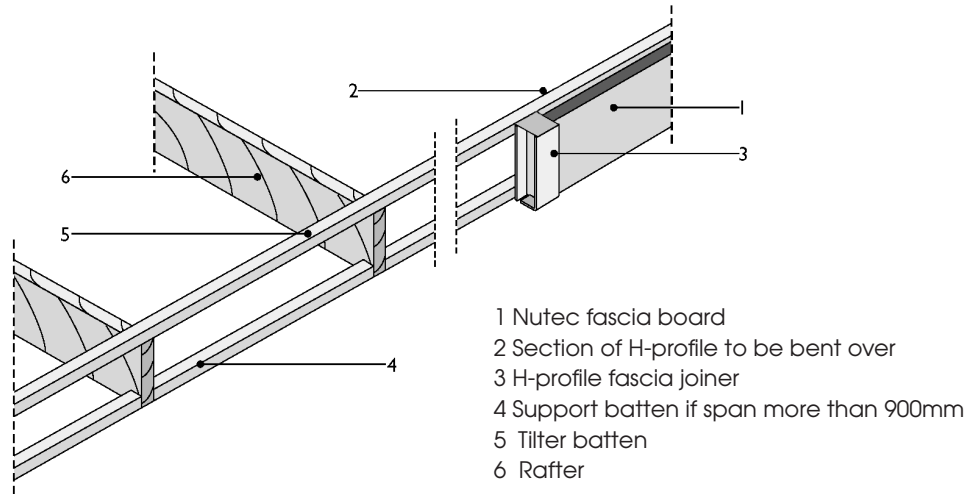
### Supporting Structure

**FIG. 1 Normal Fixing Without Additional Supporting Structure**

- 1 Nutec fascia
- 2 H-profile fascia joiner
- 3 Rafter
- 4 Fixing holes



**FIG. 2** Additional Support Required For Nutec Fascia Boards Where Distance Between Rafters Exceeds 900mm



## Joining Systems

Various joining systems for Nutec fascia boards are illustrated in **Fig 3, Page 6** and **Fig. 4, Page 7**.

**FIG. 3** Joint Detail Using H-Profile Fascia Joiners

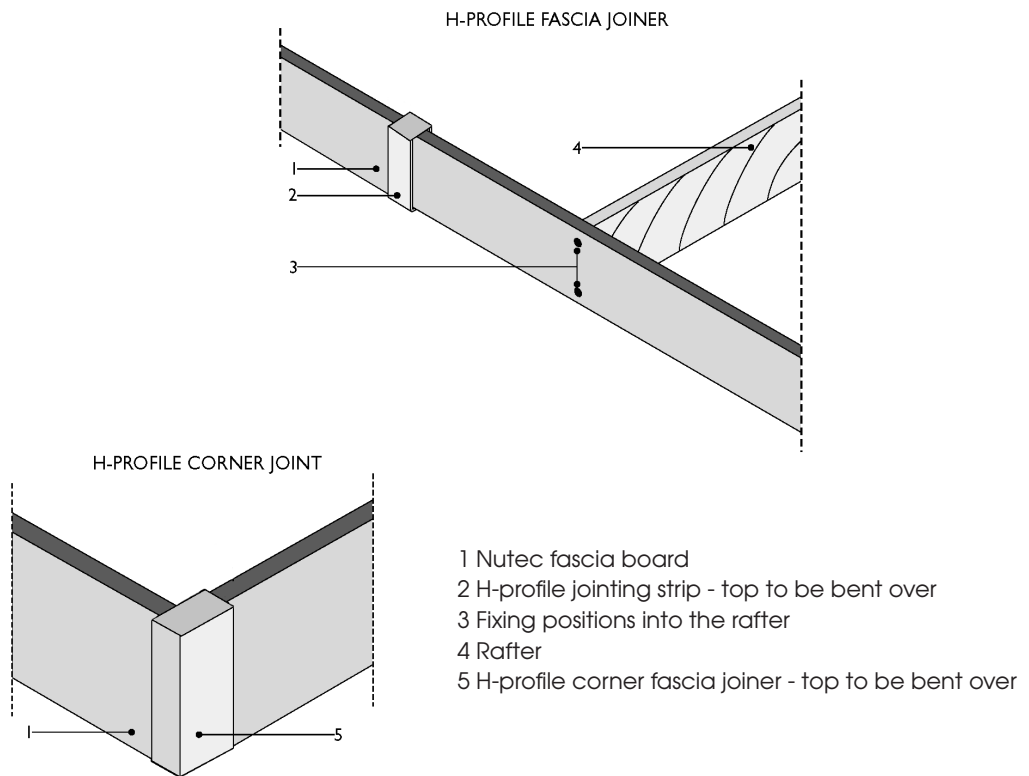
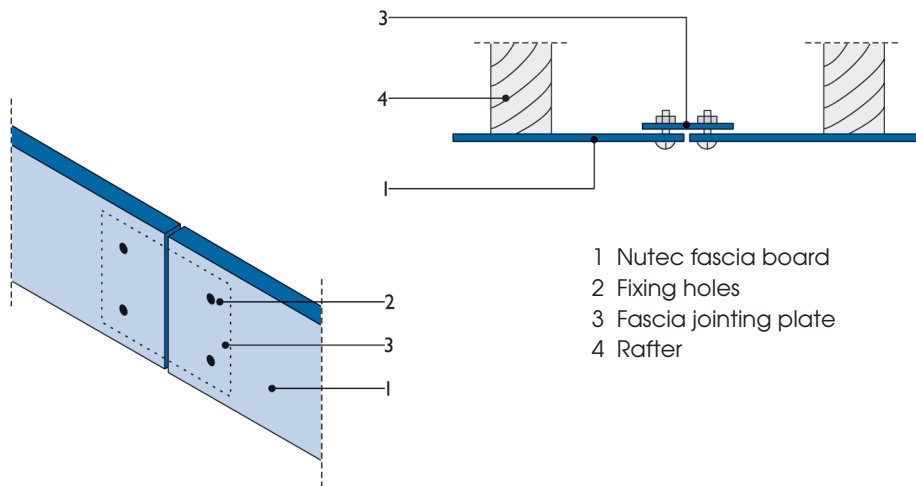


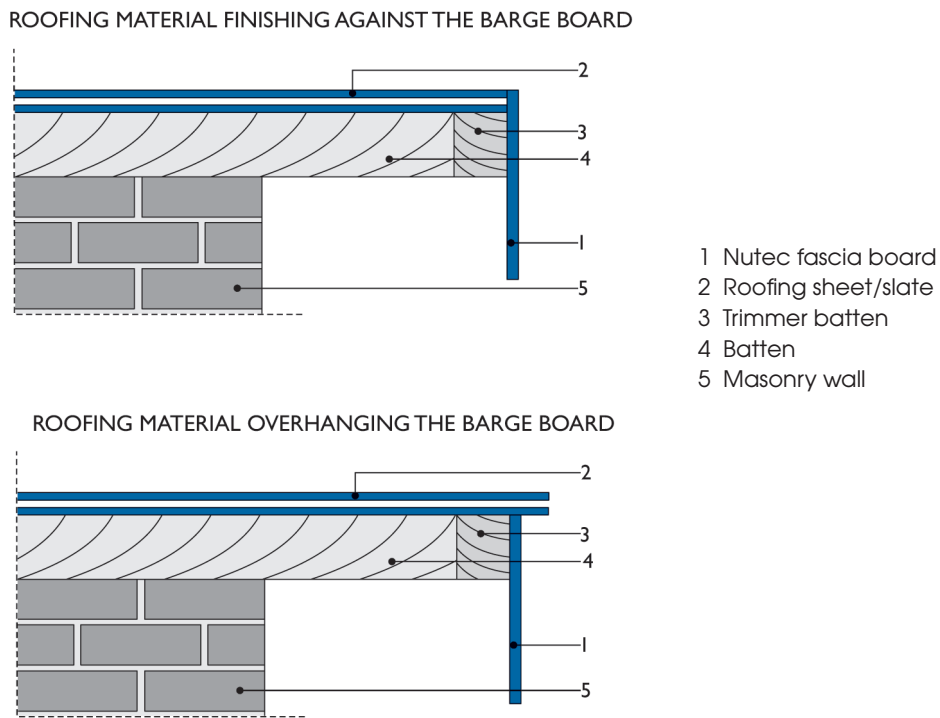
FIG. 4 Joint Detail Using Fascia Joining Plate





Using Nutec Fascia Boards As Barge Boards

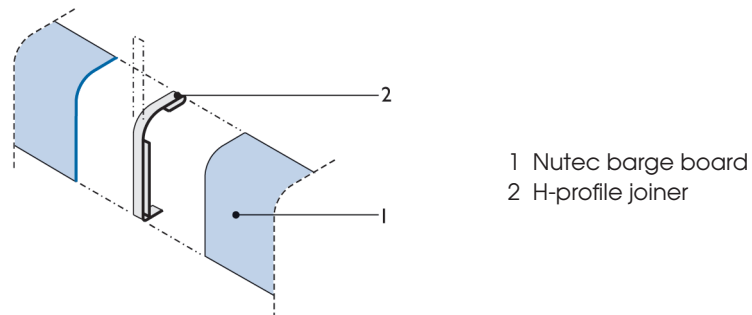
FIG. 7 Two Methods That Can Be Employed When A Nutec Fascia Board Is Used As A Barge Board



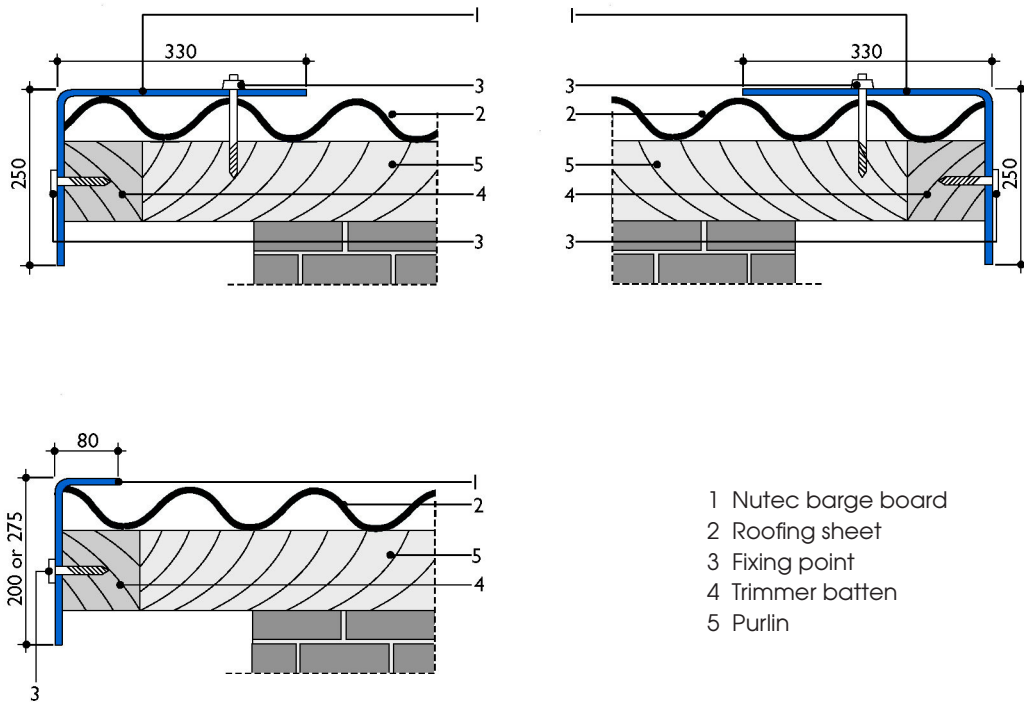
Moulded Barge Boards

A range of moulded Nutec barge boards to suit most roofing material is available and the illustrations which follow should provide clear guidelines on installation and jointing.

FIG. 8 Joint Detail Using H-Profile Joiner With 90° Moulded Barge Board

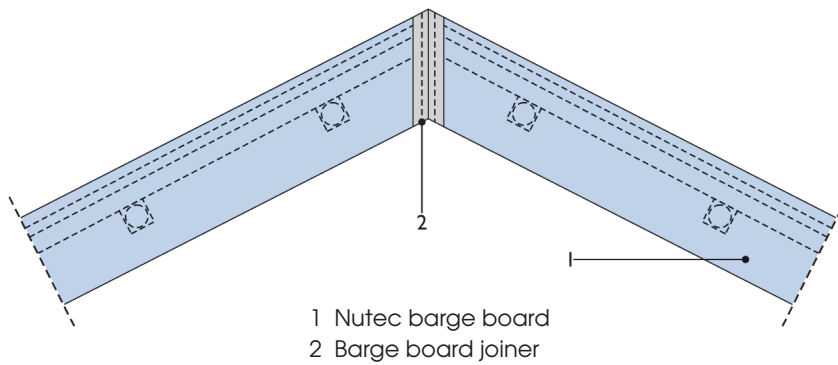


**FIG. 9** Using A 90° Moulded Barge Board On A Gable End



**NB:** In exposed and windy conditions, it is recommended that both wings of the Nutec barge boards are fixed.

**FIG. 10** Joint Detail For Barge Boards At Apex Of Roof



## Nutec Fascia Boards

### Medium Density - Plain

Product number	Thickness mm	Size mm	Length mm	Average Mass kg
041-201	12	150	3 000	8,0
041-202	12	225	3 000	11,0
041-203	12	300	3 000	15,0
041-204	12	150	3 600	9,0
041-205	12	225	3 600	14,0
041-206	12	300	3 600	18,0
040-906	10	150	3 000	6,0
040-904	10	225	3 000	10,0
041-237	10	300	3 000	13,0
041-231	10	150	3 600	8,0
040-903	10	225	3 600	12,0
040-902	10	300	3 600	15,0

### Medium Density - Timber Grain

Product number	Thickness mm	Size mm	Length mm	Average Mass kg
040-907	9	150	3 600	7,0
040-908	9	225	3 600	10,0

### Victorian Fascias

Product number	Thickness mm	Size mm	Length mm	Average Mass kg
754 - 510	6	225	1 000	2,3
754 - 511	9	225	1 000	3,4

## Socketless Nutec Barge Boards

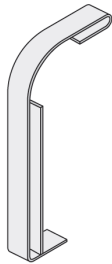
Product no.	Size mm		Length mm	Average Mass Kg	Sketch of Article
	Dimension A	Dimension B			
721-767	100	75	3 000	6,0	
721-731	200	80	3 000	6,0	
721-740	275	80	3 000	11,0	
721-780	260	260	3 000	16,0	

## Fixing Accessories

### Fascia Joiners

Product no.	Size mm	Length mm	Average Mass kg	Sketch of Article
685-240 685-241 685-242	H-profile fascia joiners - Plastic	150 x 10 225 x 10 300 x 10	0,05 0,07 0,09	
685-243 685-244 685-245		150 x 12 225 x 12 300 x 12	0,05 0,07 0,09	
685-246 685-247 685-248		150 x 15 225 x 15 300 x 15	0,05 0,07 0,09	
685-260 685-261 685-262	H-profile fascia corner joiners - Plastic	150 x 10 225 x 10 300 x 10	0,05 0,07 0,09	
685-263 685-264 685-265		150 x 12 225 x 12 300 x 12	0,05 0,07 0,09	
685-266 685-267 685-268		150 x 15 225 x 15 300 x 15	0,05 0,07 0,09	
685-090 685-091 685-092	H-profile fascia joiners Steel 10mm	150 x 10 225 x 10 300 x 10	0,05 0,07 0,09	
685-093 685-094 685-095	H-profile fascia joiners Steel 12mm	150 x 10 225 x 10 300 x 10	0,05 0,07 0,09	
685-096 685-097 685-098	H-profile fascia joiners Steel 15mm	150 x 10 225 x 10 300 x 10	0,06 0,08 0,10	
685-100 685-101 685-102	H-profile fascia corner joiners Steel 10mm	150 x 10 225 x 10 300 x 10	0,05 0,08 0,10	
685-103 685-104 685-105	H-profile fascia corner joiners Steel 12mm	150 x 10 225 x 10 300 x 10	0,06 0,09 0,12	
685-106 685-107 685-108	H-profile fascia corner joiners Steel 15mm	150 x 10 225 x 10 300 x 10	0,06 0,08 0,10	

### Barge Board Joiners

Product no.	Description	Size mm	Average Mass kg	Sketch of Article
685-189	Aluminium H-Profile	260 x 260	0,1	
685-981	Chromaprep H-profile	260 x 260	0,2	
685-231	Plastic H-Profile	200 x 80	0,1	
685-232	Barge Joiners	275 x 80	0,1	
685-087	Steel H-Profile	200 x 80	0,1	
685-088	Barge Board Joiners	275 x 80	0,1	

### Victorian Fascia Joiners Chromaprep

Product no.	Description	Size mm	Average Mass kg
685-089		180mm x 6mm	0,04
685-979		180mm x 9mm	0,06

### Screws and Nails

Use hardened steel nails with fluted shanks for best results. An alternative method would be to use No. 12 x 40mm brass wood screws with countersunk heads.

## Description

### Preamble

Nutec fascias and barge boards shall be EVERITE as detailed in their current catalogue.

Nutec fascias and barge boards shall be used strictly in accordance with EVERITE's instructions or as directed by and after consultation with EVERITE.

The contractor shall upon request of the architect, furnish him with written proof that EVERITE has been consulted. EVERITE Nutec fascia boards and Nutec barge boards are available in sizes and textures as tabled in their catalogue.

Product numbers are omitted in the case of special items, i.e. made to order items which are not kept in stock.

### Fascia boards

Nutec fascia boards, high density plain, medium density, plain or textured, fittings and fixing accessories, fixed with nails or screws specify to (specify type and material)(supporting structure elsewhere measured) with and including jointing strip for butt-jointing and corner jointers (specify type and product no.) including all cutting and waste (measured net).

- 1. Nutec fascia boards (quote relevant product number) (measured net) m
- 2. Extra over for fascia joiners (specify type and product no.) ea
- 3. Extra over for fascia corner joiners (specify type and product no.) ea

### Barge Boards

Nutec barge boards, either socketed or plain, fittings and fixing accessories fixed to (specify type and material) (with nails or screws specify) (supporting structure elsewhere measured) with an including jointing strip for butt-jointing and for apex jointing (specify type and product numbers) including all cutting and waste (measured net).

- 1. Nutec barge boards (quote relevant product number). (measured NETT.) m

Quantity	Rate	Amount

**Call Centre - 0861 333 835**  
**www.everite.co.za**

**Sales Support Office**

P O Box 8644 Johannesburg 2000  
 Heidelberg Road Kliprivier Gauteng  
 Telephone (011) 439 4400  
 Telefax (011) 903 7097

**Cape Town**

P O Box 26 Brackenfell 7561  
 Ground Floor Corporate Place  
 Mispel Street Belville  
 Telephone (021) 941 8640  
 Telefax (021) 941 8641

**Durban**

P O Box 1532 Wandsbeck 3631  
 1st Floor Kent House  
 1 Neptune Road Essex Terrace  
 Westville 3629  
 Telephone (031) 267 1903  
 Telefax (031) 267 1907

**Bloemfontein**

P O Box 981 Bloemfontein 9300  
 76/80 President Reitz Street  
 Reitz Park Westdene  
 Telephone (051) 448 7433  
 Telefax (051) 448 7435

**East London**

P O Box 679 East London 5200  
 3 Suffolk Road Berea  
 Mobile (079) 516 6510  
 Telefax (043) 726 0343

**George**

P O Box 444 George 6530  
 Building Exhibit Centre  
 Corner Market & Hope St George  
 Telephone (044) 873 2408  
 Mobile (083) 286 3435  
 Telefax (044) 873 2409

**Middelburg (Mpumalanga)**

P O Box 7017 Kanonkop  
 Middelburg 1050  
 Mobile (083) 778 2787  
 Telefax (013) 244 2629

**Polokwane**

P O Box 552  
 Polokwane 0700  
 26, 20th Avenue Industria  
 Telephone (015) 297 3559/62  
 Telefax (015) 297 3424

**Port Elizabeth**

P O Box 34323  
 Newton Park 6055  
 Propnet Park Ries Street  
 Deal Party  
 Telephone (041) 401 8900  
 Mobile (083) 780 6162  
 Telefax (041) 486 1884

**Worcester**

P O Box 492  
 Worcester 6851  
 1 Nassau Street Worcester  
 Mobile (083) 286 3431  
 Telefax (023) 342 6966

**Botswana (Gaborone)**

Private Bag 003 Suite 466  
 Mogoditshane  
 Botswana  
 Mobile (00267) 7 263 9887  
 Telefax (00267) 316 7753

**Namibia**

P O Box 894  
 Swakopmund  
 Mobile (00264) 81 124 2655  
 Telefax (00264) 64 40 3733